

SPECIFICATIONS

HOUSING MATERIAL/COLOR

NYLON 66/BLACK

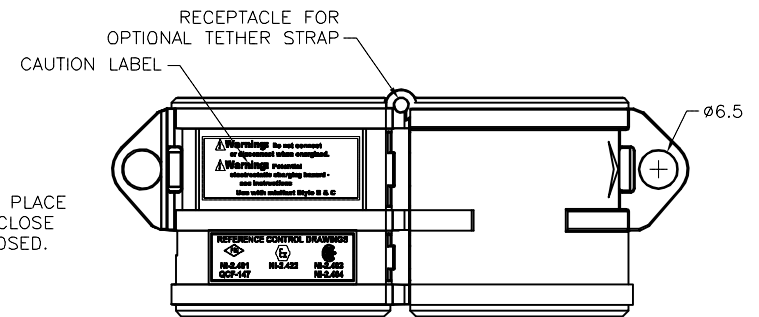

OPENED VIEW OF LOCKOUT DEVICE

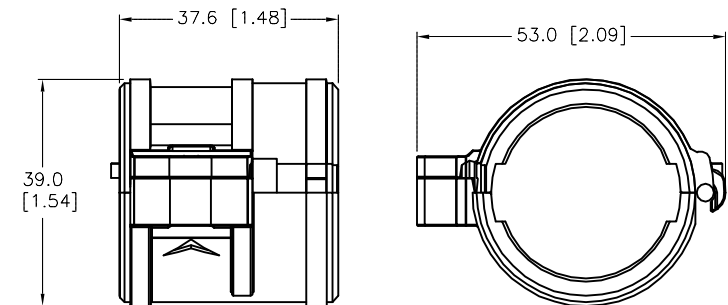

LOCKOUT DEVICE FITS ALL STRAIGHT TURCK MOLDED B & C MINIFAST CORDSETS.

SOURCE DRAWING - FOR REFERENCE ONLY

RELATED DOCUMENTS		3RD ANGLE PROJECTION		<div>THIS DRAWING IS CONFIDENTIAL AND THE PROPERTY OF TURCK INC. USE OF THIS DOCUMENT WITHOUT WRITTEN PERMISSION IS PROHIBITED.</div> <div>TURCK</div>		<div>3000 CAMPUS DRIVE MINNEAPOLIS, MN 55441 1-800-544-7769 (763) 553-7300 (763) 553-0708 fax www.turck.us</div>		
1. 2. 3. 4.								
MATERIAL		DRFT RDS		DATE 01/12/06		DESCRIPTION LOCK-MINI-B&C (10/BAG)		
FINISH		APVD		SCALE 1=1.3				
		UNIT OF MEASUREMENT MILLIMETERS		IDENTIFICATION NO. A0940		REV A		
ALL DIMENSIONS DISPLAYED ON THIS DRAWING ARE FOR REFERENCE ONLY		CONTACT TURCK FOR MORE INFORMATION		DO NOT SCALE THIS DRAWING		FILE: A0940		SHEET 1 OF 1

TO INSTALL LOCKOUT DEVICE, PLACE AROUND CORDSET END AND CLOSE UNTIL CONNECTOR SNAPS CLOSED.

TO REMOVE LOCKOUT DEVICE, INSERT SMALL SCREWDRIVER INTO LOCKING GROOVE AS SHOWN IN PICTURE. ROTATE SCREWDRIVER IN DIRECTION SHOWN UNTIL LOCKING DEVICE RELEASES.